



Sorting Records

Tech Tips - IBM SPSS Modeler

Tech Tips – Sorting Records

- Here’s a quick tip to sort records in IBM SPSS Modeler.
- Sometimes you want to sort records in a data file. For example, you want to sort your data by income and age so that cases with lowest incomes and ages are at the top of your file.
- The **Sort** node makes sorting easy and is located on the **Record Ops** palette.

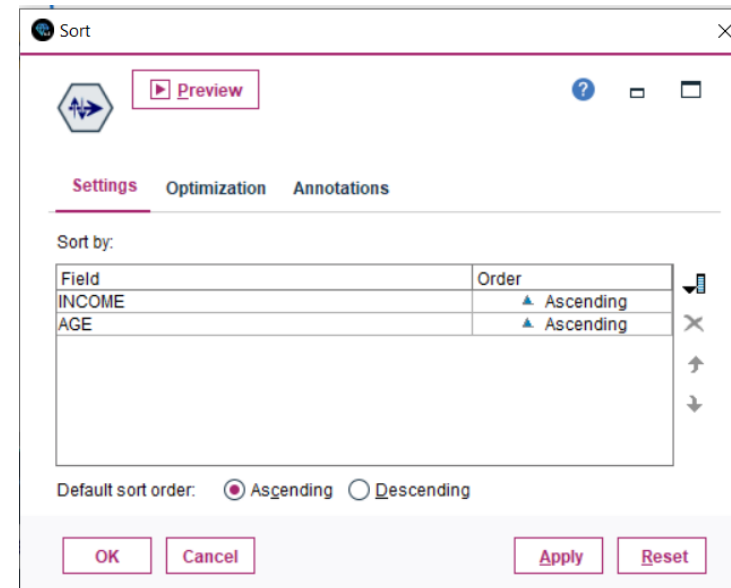
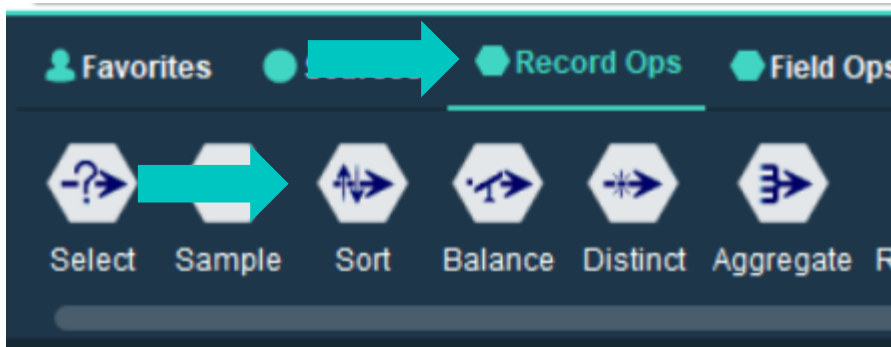

Tech Tips – Sorting Records

- To sort records go to the **Record Ops** palette. Select the **Sort** node and drag it onto the stream canvas. You can also double click the node to drop it onto the stream canvas. Once it is on the canvas you can connect it to your stream.
- Double click to open the node.

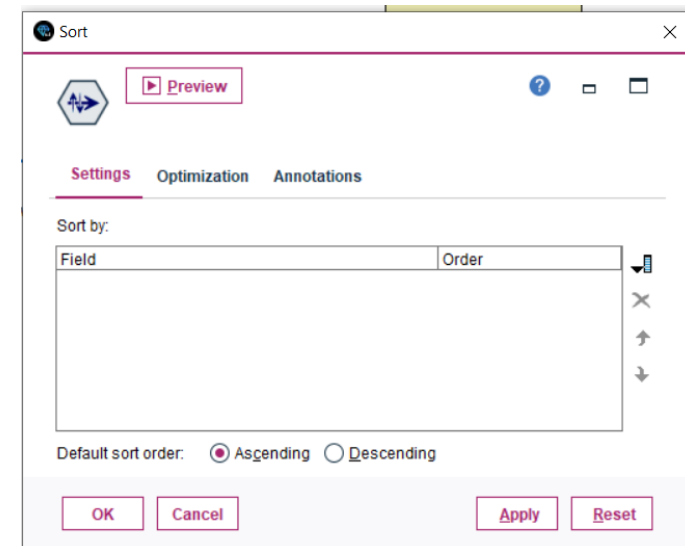
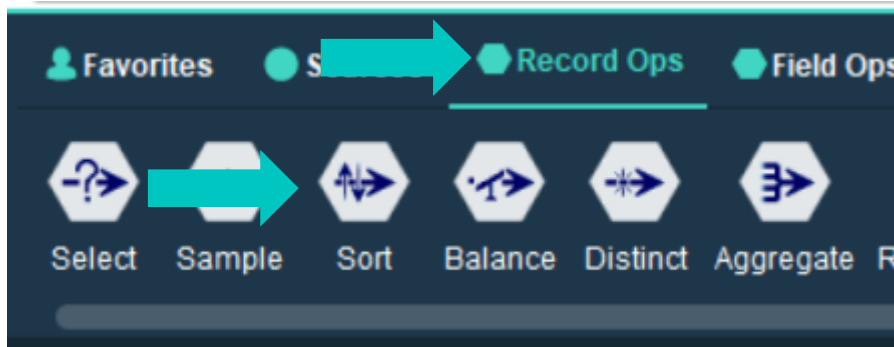

Tech Tips – Sorting Records

- Once the node is open, use the field chooser button to select the field(s) to sort. We will select 'INCOME' and 'AGE'. Note to the right we can select **Ascending** or **Descending**. Click **OK**.

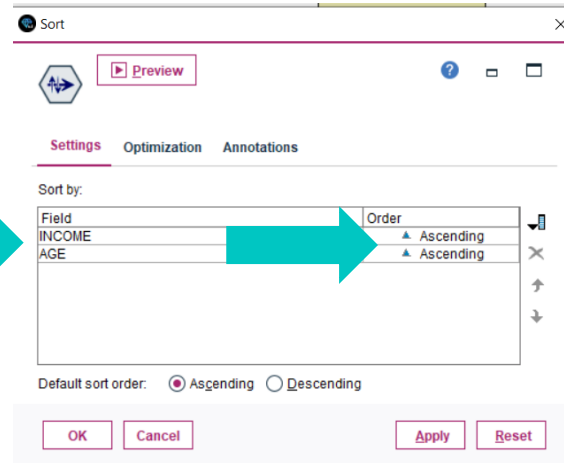
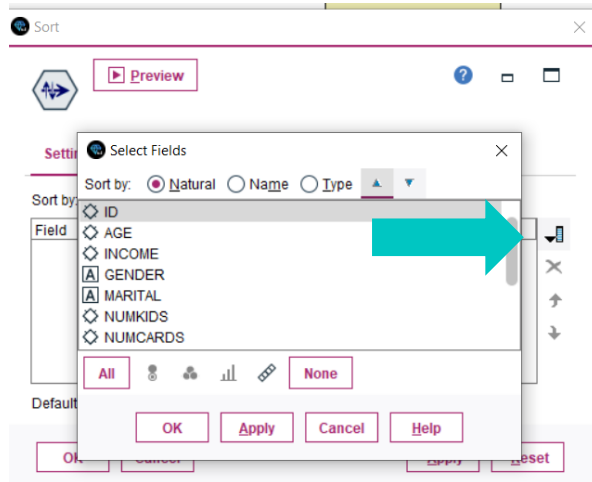

Preview from Sort Node (12 fields, 10 records) #2

	ID	INCOME	AGE	GENDER	MARITAL	NUMKIDS	NUMCARDS	HOWPAID
1	101819	15018	24	m	married	1	2	monthly
2	101602	15032	23	f	married	1	1	monthly
3	101121	15035	20	m	married	2	2	weekly
4	102584	15045	24	m	single	1	1	monthly
5	102172	15050	21	f	single	0	3	monthly
6	101958	15051	25	m	married	1	0	monthly
7	102142	15052	21	m	single	0	3	weekly
8	102590	15055	28	m	single	1	3	monthly
9	103567	15056	48	m	divsepwid	4	6	weekly
10	101118	15064	20	m	married	1	2	monthly



Thank You

For more information
please visit spssanalyticspartner.com