

Sampling Records

Tech Tips - IBM SPSS Modeler

Tech Tips – Sampling Records

- Here’s a quick tip to sample records in IBM SPSS Modeler.
- Sometimes you want to sample from a data file. For example, you want to build a model using millions of records. To transform data and build the model, you can use a random sample from the data file.
- The **Sample** node makes sampling data easy and is located on the **Record Ops** palette.

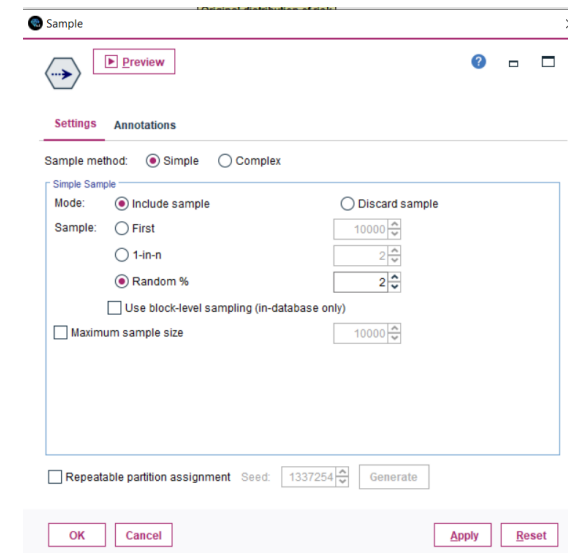
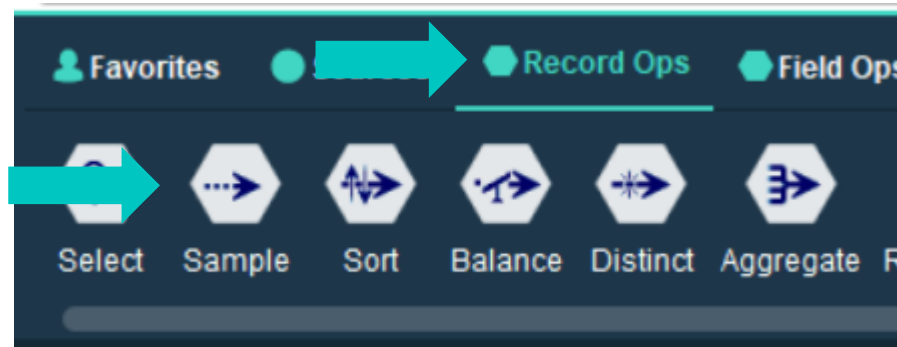

Tech Tips – Sampling Records

- To sample data go to the **Record Ops** palette. Select the **Sample** node and drag it onto the stream canvas. You can also double click the node to drop it onto the stream canvas. Once it is on the canvas you can connect it to your stream.
- Double click to open the node. We want to take a small (5%) random sample from our data. Under **Sample** select **Random %**. Enter the proportion value. Click **OK**.

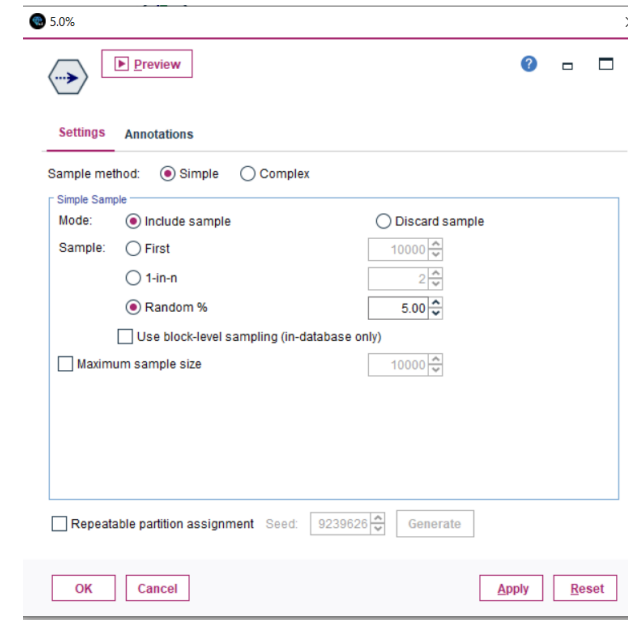
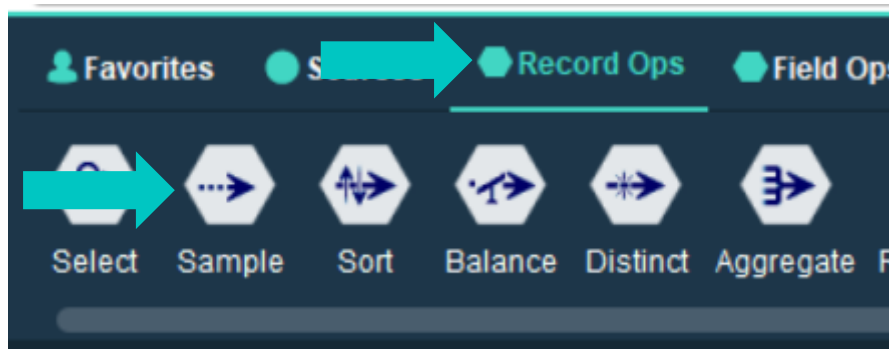

Tech Tips – Sampling Records

- Now we have a smaller random sample. The **Sample** node will show the proportion take on the node.

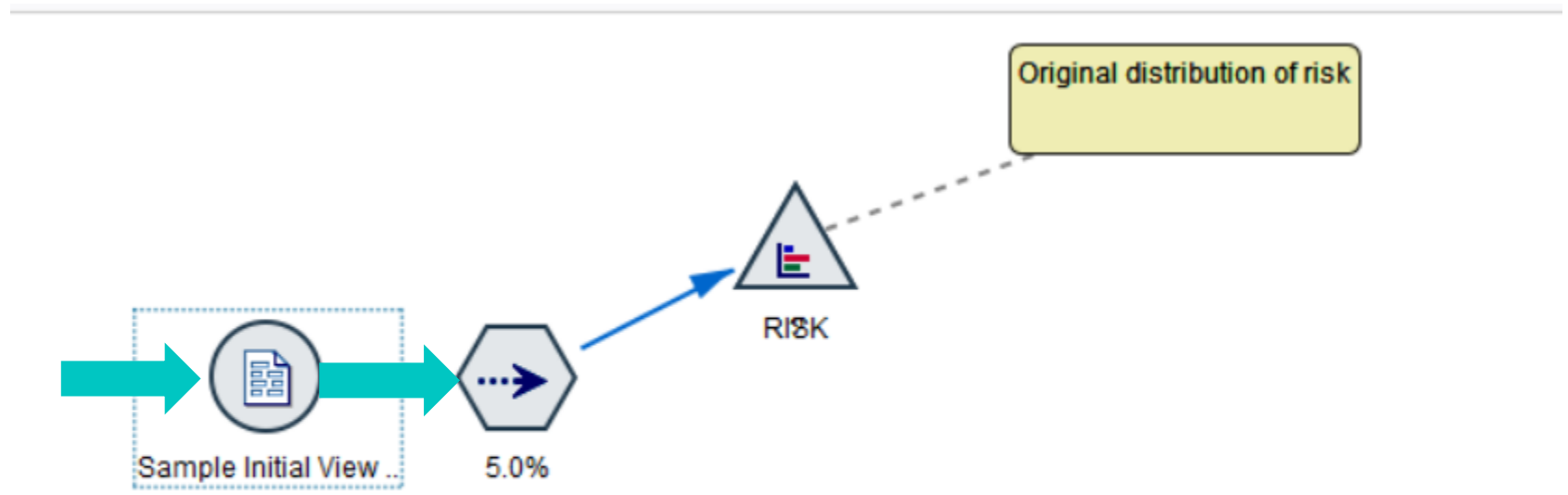

Thank You

For more information
please visit spssanalyticspartner.com