

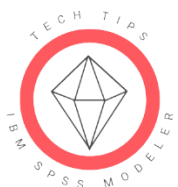

Tech Tips - Comparing Means in IBM SPSS Modeler

Tech Tips - Comparing Means in IBM SPSS Modeler



Tech Tips - Examine Statistics

- Here's a quick tip to compare means in IBM SPSS Modeler.
- Sometimes you want to examine variable relationships and you want to compare averages across groups. The Means node makes this quick and easy. The **Means** node is located on the **Output** palette.

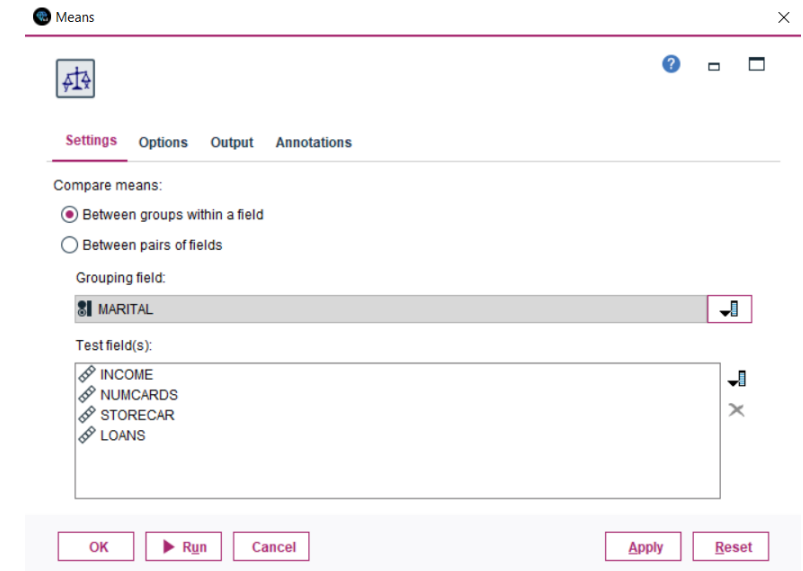
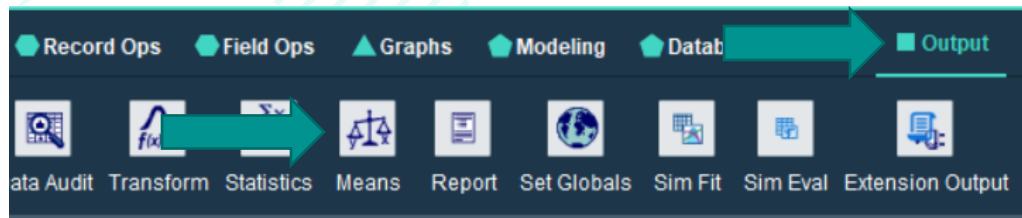

Tech Tips - Examine Statistics

- To obtain a comparison of means go to the **Output** palette. Select the **Means** node and drag it onto the stream canvas. You can also double click the node to drop it onto the stream canvas. Once it is on the canvas you can connect it to your stream.
- Double click to open the node. Use the field chooser button to select the **Grouping field**. In the **Test field(s)** select fields. Click **Run**.

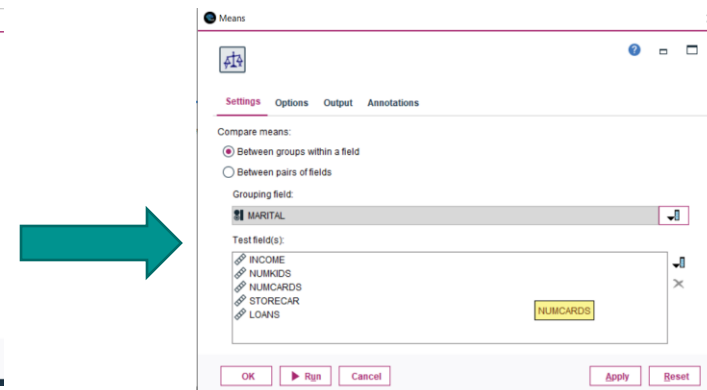
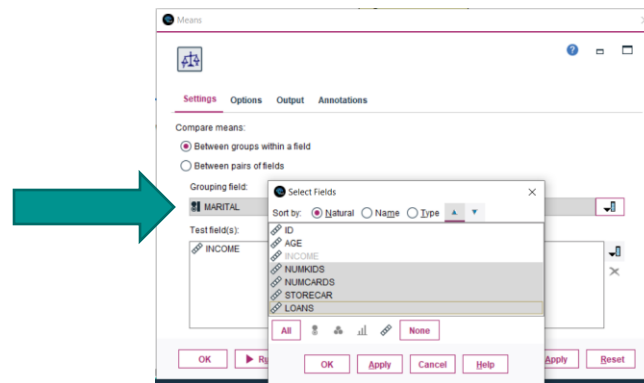
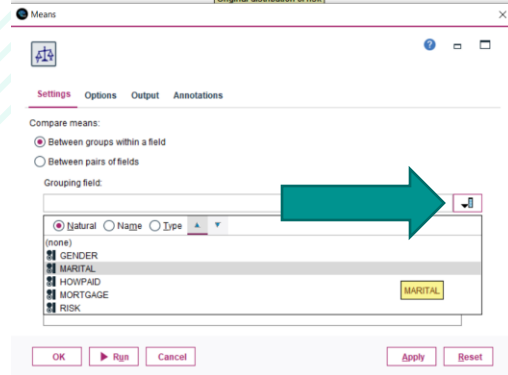

Tech Tips - Examine Statistics

- The output shows averages across categories of marital status. The **Importance** column shows that there are significant statistical differences across categories of marital status.

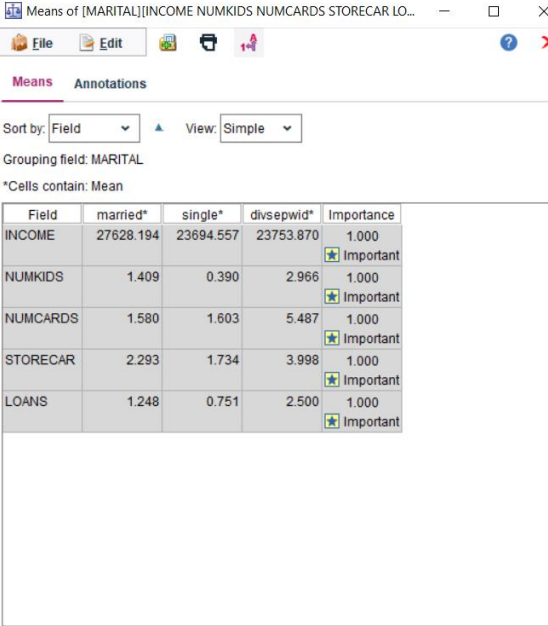

Means of [MARITAL][INCOME NUMKIDS NUMCARDS STORECAR LO... - □ ×

File Edit

Means Annotations

Sort by: Field View: Simple

Grouping field: MARITAL

*Cells contain: Mean

Field	married*	single*	divsepwid*	Importance
INCOME	27628.194	23694.557	23753.870	1.000 Important
NUMKIDS	1.409	0.390	2.966	1.000 Important
NUMCARDS	1.580	1.603	5.487	1.000 Important
STORECAR	2.293	1.734	3.998	1.000 Important
LOANS	1.248	0.751	2.500	1.000 Important

OK

SPSS Tech Tips

For more **Tech Tips**, go to the Tech Tips section within the Learning Hub.

Contact us



SPSSAdmin@version1.com



+ 44 (0) 203 859 4790
+ 353 (0) 1 865 7800



www.spssanalyticspartner.com



Thank you.